

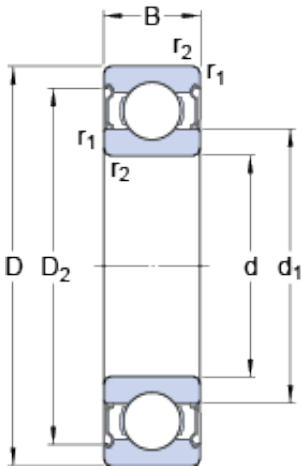

# NTN Bearing Rolamentos do Brasil Ltda.



130 mm x 200 mm x 33 mm skf 6026-2Z Deep groove ball bearings

Bearing No. 6026-2Z

6026-2Z Bearing 2D drawings and 3D CAD models

Size	200x130x33 mm
Bore Diameter	200 mm
Outer Diameter	130 mm
Width	33 mm
d	130 mm
D	200 mm
B	33 mm
d <sub>1</sub>	152.6 mm
D <sub>2</sub>	181.4 mm
r <sub>1,2</sub> - min.	2 mm
d <sub>a</sub> - min.	139 mm
d <sub>a</sub> - max.	152.9 mm
D <sub>a</sub> - max.	191 mm
r <sub>a</sub> - max.	2 mm
Basic dynamic load rating - C	112 kN
Basic static load rating - C <sub>0</sub>	100 kN
Fatigue load limit - P <sub>u</sub>	3.4 kN
Reference speed	7000 r/min
Limiting speed	3400 r/min
Calculation factor - k <sub>r</sub>	0.025
Calculation factor - f <sub>0</sub>	15.8
Category	Single Row Ball Bearings
Inventory	0.0
Manufacturer Name	SKF



## NTN Bearing Rolamentos do Brasil Ltda.

Minimum Buy Quantity	N/A
Weight / Kilogram	3.41
EAN	7316570559477
Product Group	B00308
Enclosure	2 Metal Shields
Precision Class	ABEC 1   ISO P0
Maximum Capacity / Filling Slot	No
Rolling Element	Ball Bearing
Snap Ring	No
Internal Special Features	No
Cage Material	Steel
Internal Clearance	C0-Medium
Inch - Metric	Metric
Long Description	130MM Bore; 200MM Outside Diameter; 33MM Outer Race Diameter; 2 Metal Shields; Ball Bearing; ABEC 1   ISO P0; No Filling Slot; No Snap Ring; No Internal Special Features
Category	Single Row Ball Bearing
UNSPSC	31171504
Harmonized Tariff Code	8482.10.50.68
Noun	Bearing
Keyword String	Ball
Manufacturer URL	<a href="http://www.skf.com">http://www.skf.com</a>
Manufacturer Item Number	6026-2Z
Weight / LBS	7.51
Bore	5.118 Inch   130 Millimeter
Outer Race Width	1.299 Inch   33 Millimeter
Outside Diameter	7.874 Inch   200 Millimeter
bore diameter:	130 mm
static load capacity:	100 kN



## NTN Bearing Rolamentos do Brasil Ltda.

outside diameter:	200 mm
precision rating:	Not Rated
overall width:	33 mm
finish/coating:	Uncoated
bore type:	Round
cage material:	Steel
closure type:	Double Shielded
outer ring width:	33 mm
row type & fill slot:	Single Row Non-Fill Slot
fillet radius:	2 mm
internal clearance:	C0
maximum rpm:	3400 RPM
dynamic load capacity:	112 kN
series:	60
$d_1$	152.6 mm
$D_2$	181.4 mm
$r_{1,2}$ min.	2 mm
$d_a$ min.	139 mm
$d_a$ max.	152.9 mm
$D_a$ max.	191 mm
$r_a$ max.	2 mm
Basic dynamic load rating C	112 kN
Basic static load rating $C_0$	100 kN
Fatigue load limit $P_u$	3.35 kN
Calculation factor $k_r$	0.025
Calculation factor $f_0$	15.8
Mass bearing	3.36 kg