

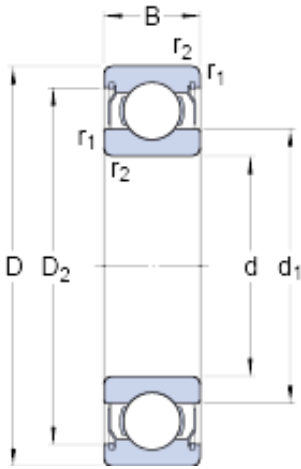

# NTN Bearing Rolamentos do Brasil Ltda.



7 mm x 11 mm x 3 mm skf W 627/7-2ZS Deep groove ball bearings

Bearing No. W 627/7-2ZS

W 627/7-2ZS Bearing 2D drawings and 3D CAD models

|   |              |
|---|--------------|
| Size                                      | 11x7x3 mm    |
| Bore Diameter                             | 11 mm        |
| Outer Diameter                            | 7 mm         |
| Width                                     | 3 mm         |
| d   | 7 mm         |
| D   | 11 mm        |
| B   | 3 mm         |
| d <sub>1</sub>                            | 8.04 mm      |
| D <sub>2</sub>                            | 10.26 mm     |
| r <sub>1,2</sub> - min.                   | 0.15 mm      |
| d <sub>a</sub> - min.                     | 7.9 mm       |
| d <sub>a</sub> - max.                     | 8 mm         |
| D <sub>a</sub> - max.                     | 10.3 mm      |
| r <sub>a</sub> - max.                     | 0.15 mm      |
| Basic dynamic load rating - C             | 0.26 kN      |
| Basic static load rating - C <sub>0</sub> | 0.104 kN     |
| Fatigue load limit - P <sub>u</sub>       | 0.004 kN     |
| Reference speed                           | 110000 r/min |
| Limiting speed                            | 56000 r/min  |
| Calculation factor - k <sub>r</sub>       | 0.015        |
| Calculation factor - f <sub>0</sub>       | 8.1          |
| d <sub>1</sub>                            | 8.04 mm      |
| D <sub>2</sub>                            | 10.26 mm     |
| r <sub>1,2</sub> min.                     | 0.15 mm      |



## NTN Bearing Rolamentos do Brasil Ltda.

|                                |            |
|--------------------------------|------------|
| $d_a$ min.                     | 7.9 mm     |
| $d_a$ max.                     | 7.9 mm     |
| $D_a$ max.                     | 10.3 mm    |
| $r_a$ max.                     | 0.15 mm    |
| Basic dynamic load rating C    | 0.26 kN    |
| Basic static load rating $C_0$ | 0.104 kN   |
| Fatigue load limit $P_u$       | 0.004 kN   |
| Calculation factor $k_r$       | 0.015      |
| Calculation factor $f_0$       | 8.1        |
| Mass bearing                   | 0.00072 kg |